



# MAGTEK IA

## Thermally insulated aluminium manual attack resistant doors windows and partitions

**Reducing the consumption of energy in buildings and protecting the environment is a major challenge for many companies.**

Fichet's manual attack resistant doors have been designed to satisfy the ever increasing need to protect people, property and assets from theft and attack, whilst maintaining an elegant appearance and saving energy.

The MagTek IA range is made up of enhanced manual attack resistant doors to protect against vandalism. It features fully certified doors that have been tested by independent bodies in accordance with the relevant European standards and is compliant with the Directive of the European Parliament on the energy performance of buildings. This way, Fichet can be sure of meeting all client requirements and expectations, providing a solution that offers the right protection against the identified risk. Since aluminium is a material that is easy

to shape and form, the MagTek IA is an optimal solution that combines design and functional requirements.

The ease with which they can be integrated into buildings and the wide range of design choices available (dimensions, finishes and colours) mean that MagTek IA doors are versatile, and can be used for both building refurbishments and new constructions.

The MagTek IA range also includes a selection of partitions so that complete facade or enclosure solutions can be designed.

# MAGTEK IA

## Material

<b>Framework</b>	Thermally insulated extruded aluminium profile with the inclusion of special steel armour depending upon the resistance level
<b>Infill</b>	Laminated security glass or solid infill made of an aluminium panel on the attack side and white colour laminate on the secure side
<b>Finish</b>	Powder coat to RAL 9010, 9006, 7035 or 7037

## Standard equipment

<b>Locking</b>	3-point mechanical Euro Lock
<b>Handle</b>	Pad handle on both sides

## Construction

<b>Opening</b>	Up to 150° (depending on model)
<b>DIN</b>	Left or right
<b>Standard clear opening</b>	900mm at 90° opening: 1 leaf 1400mm at 90° opening: 2 leaves

## Reference standard

The MagTek IA is tested to EN 1627 for the complete doorset. Standard EN 1627 includes 3 level of tests. The physical attack component which includes different sets of tools and attack times is in accordance with EN 1630.

## Models

- Thermally Insulated Enhanced Manual Attack Resistant Doors – MagTek IA0 Lite & IA3 Lite
- Thermally Insulated Certified Manual Attack Resistant Doors – MagTek IA4

## Applications

- Banks
- Embassies
- Government buildings
- Military sites
- Cash Centers

- Police stations
- Prisons
- ...

## Options

- Alternative RAL colours or anodised finish\*
- Leaf position contact switch
- High security cylinder
- Choice of mechanical Euro locks and electric locks
- Push buttons
- Choice of handle types
- Anti-panic bar (depending upon model)
- Upgrade to bullet resistance (depending upon model)

## Range composition

MagTek IA0 Lite and MagTek IA3 Lite

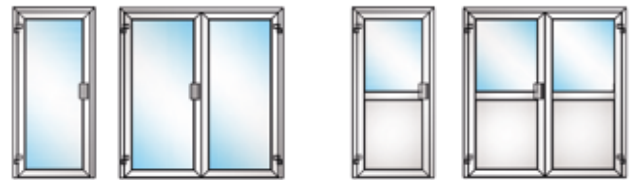

IA3-G Lite  
IA0-G Lite

IA3-G Lite  
double leaf  
IA0-G Lite  
double leaf

IA3-H Lite  
IA0-H Lite

IA3-H Lite  
double leaf  
IA0-H Lite  
double leaf

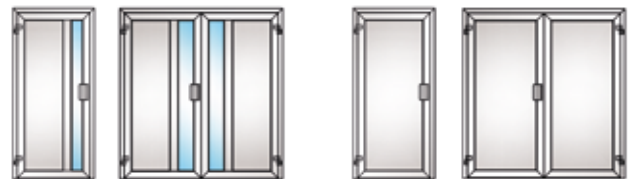

IA3-H Lite  
IA0-H Lite

IA3-H Lite  
double leaf  
IA0-H Lite  
double leaf

IA3-S Lite  
IA0-S Lite

IA3-S Lite  
double leaf  
IA0-S Lite  
double leaf

MagTek IA4



IA4-G

IA4-G double leaf

IA4-H

IA4-H double leaf



IA4-H

IA4-H double leaf

IA4-S

IA4-S double leaf

Partitions MagTek IA



IA0-G Lite | IA3-G  
Lite | IA4-G

Windows MagTek IA



IA0-G Lite | IA3-G  
Lite | IA4-G

\* Finishing is compliant with the highest Qualicoat and Qualanod quality standards

### KEY FEATURES

- Elegant appearance.
- Resistance against manual attack.
- Reduction of the consumption of energy in the building.
- Wide range of finishes and dimensions available.
- Complementary windows and partitions.
- Aluminium is a green product. It can be recycled infinitely without compromising the quality.

# MAGTEK IA

## Standard technical specifications

Model	Type	Rating	Leaf options	Total standard width: W (single/double) <sup>1</sup>	Total standard height: H <sup>1</sup>	Passage width (mm) <sup>2</sup>	Passage height (mm) <sup>2</sup>	Aluminium framework	Infill
MagTek IA0-S Lite	Enhanced manual attack resistant doors	-	Single/Double	1150 / 1720	2130	900/1400	2060 / 2060	75mm thick	Solid
MagTek IA0-G Lite									Glazed
MagTek IA3- S Lite	Certified manual attack resistant doors	Level CR3 to EN 1627-30	Single/Double	1150 / 1720	2130	900/1400	2060 / 2060	75mm thick	Solid
MagTek IA3-G Lite									Glazed
MagTek IA4-S		Level CR4 to EN 1627-30	Single/Double	1150 / 2130	2130	900 / 1800	2050	75mm thick	Solid
MagTek IA4-G									Glazed

1 : Overall dimension of the door (mm) 2 : Door opening at 90°

## Optional technical specifications

Model	FB3 to FB6 bullet resistance	Non standard width (single/double) (mm) <sup>1</sup>	Non standard height (mm) <sup>1</sup>	Electric locking
MagTek IA0-S Lite	-	910-1300/1210-2400	2050-2500	○
MagTek IA0-G Lite				
MagTek IA3- S Lite	-	910-1300/1210-2400	2050-2500	○
MagTek IA3-G Lite				
MagTek IA4-S	○	980-1280/1300-2500	2050-2500	○
MagTek IA4-G				

○ Optional  
- Not available

1 : Overall dimension of the door (mm)

Thermal Insulation Performance for the Profile  
75mm framework: UF=2,2 W/m<sup>2</sup>K. EN ISO 10077-2  
92mm framework: UF=2,49 W/m<sup>2</sup>K. EN ISO 10077-2

## Dimensions (mm)

	Door	W Overall width	PW Passage width (90°)	COW Clear opening width	H Overall height	PH Passage height
MAGTEK IA LITE (75mm-thick)	Single	W	W-240	W-160	H	H-75
	Double	W	W-320	W-160	H	H-75
MAGTEK IA (92mm-thick)	Single	W	W-220 (OO) W-350 (IO)	W-140 (OO) W-165 (IO)	H	H-70 (OO) H-82 (IO)
	Double	W	W-295(OO) W-330 (IO)	W-140 (OO) W-165 (IO)		

OO : Outward Opening  
IO : Inward Opening

RW Reserved Width/RH Reserved Height*	
Masonry (stone or concrete)	W +10mm/H +10mm

\* Valid for MagTek IA doors, windows and partitions

# MAGTEK IA

## Site preparation

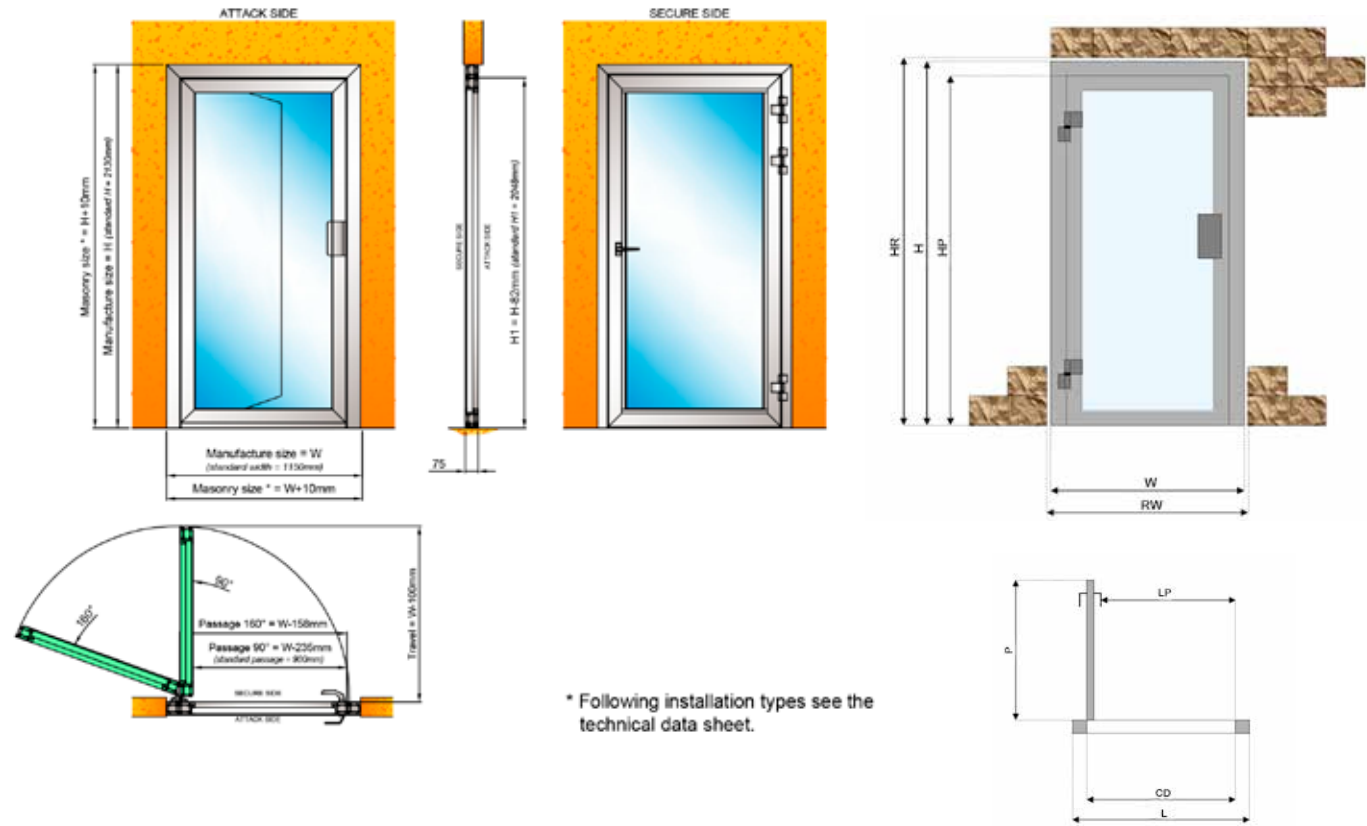

Drawings are also available for the partitions and windows.

### Notice:

- Product performance depends upon the quality of its installation. All installation details are provided in the MagTek A Installation Manual.
- Certificates for manual attack resistance are available on demand. Contact Fichet for any certificate requests.



Manual attack resistance

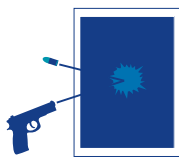

Ballistic Resistance



Emergency exit



Eco-design



Recyclable product



Energy savings